

FILL BOX KIT FOR DOUBLE WALL VERTICAL FUEL TANK

INSTALLATION GUIDE

Install Flange and Fill Box:

Connect the fill box flange assembly to the tank fill pipe assembly, using the bolt and ring gasket kit provided.

Attach the fill box assembly to the mounting plate of the flange assembly, using 4 bolts and nuts.

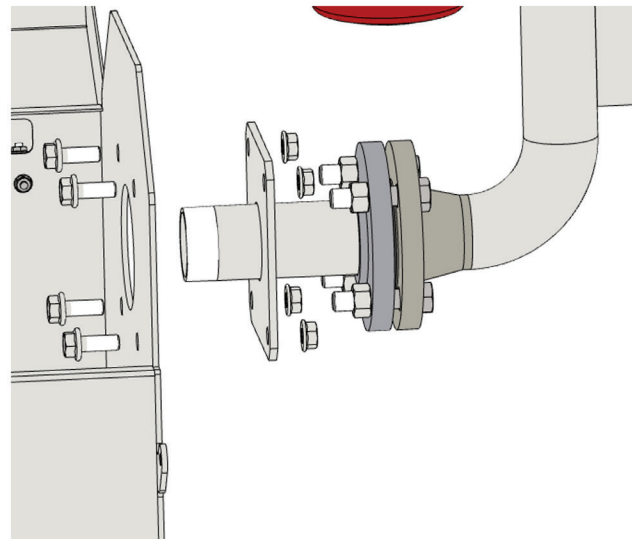
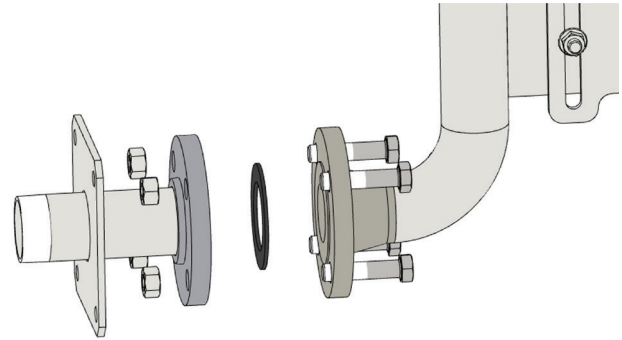

Install Leg Assemblies:

Attach 2 leg assemblies to the fill box assembly, using 2 bolts and nuts in each leg.

Loosen the bolts of the leg assemblies for adjustment, letting the foot drop to the ground.

Lift upward on the end of the fill box and with the foot extended to the ground, retighten the bolts.

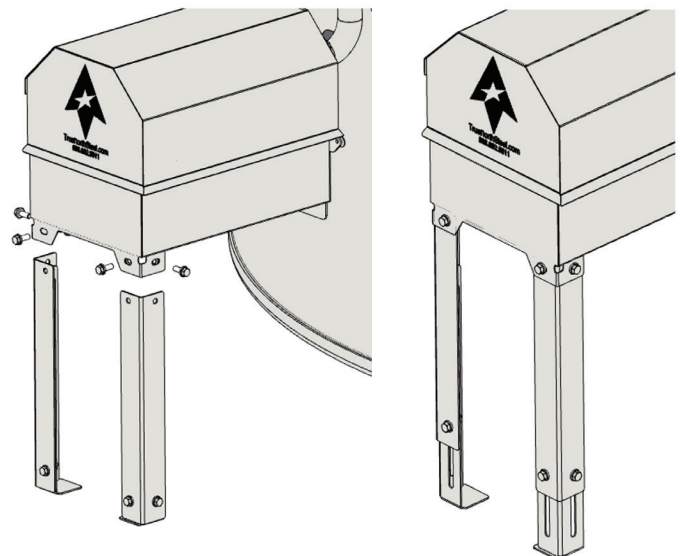

FILL BOX KIT FOR DOUBLE WALL VERTICAL FUEL TANK

Attach the nozzle holder to the side of the fill box assembly, using 2 bolts and nuts.

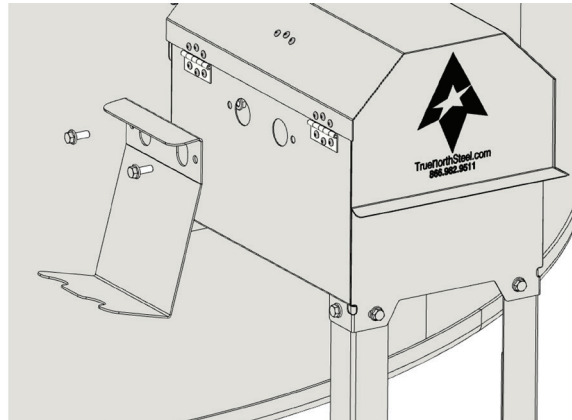

Install internal fittings:

Install the swing check valve to the flange assembly pipe inside the fill box, with the flow arrow pointing toward the flange and tank.

Attach a pipe nipple to the swing check valve and attach the ball valve to the pipe nipple.

Attach the quick coupler and dust cap to the ball valve.

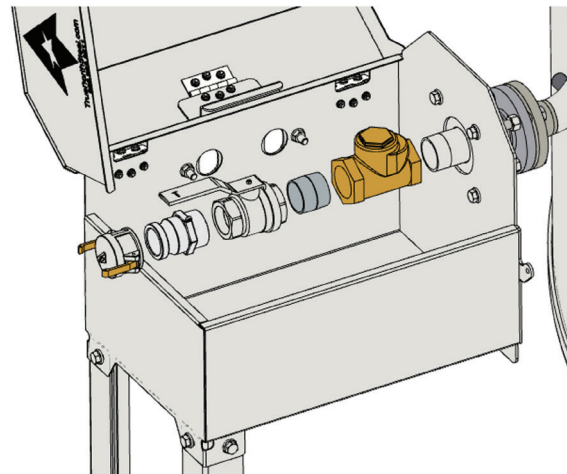

Install drain:

Connect 1/2" pipe nipple to flange on bottom of fill box and attach 1/2" ball valve to the pipe nipple to complete the installation.

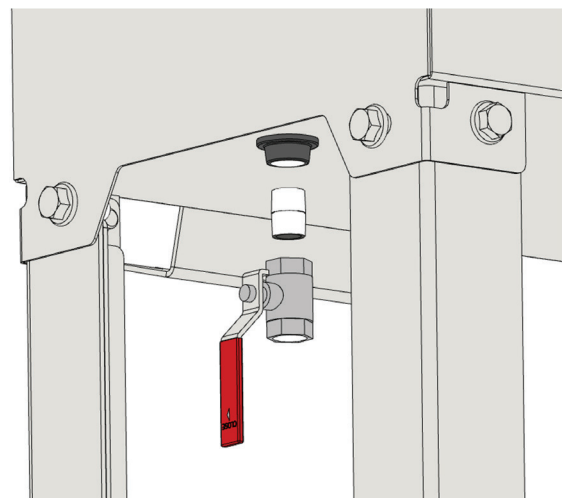

FILL BOX KIT FOR DOUBLE WALL VERTICAL FUEL TANK

Install 1/2" fuel line, connecting one end to the coupler at the elbow of the fill pipe assembly, and the other end to the pressure relief valve above the pump filters.

The fill box assembly is complete, and the nozzle(s) may be stored on the nozzle holder of the fill box.

Install the tank gauge per the manufactures instruction, using the 2"x1" bushing provided, in a 2" coupling on the top head of the tank.

